



# TIONG WOON MARINE PTE LTD

-A member of Tiong Woon Corporation Holding Ltd-

## TIONG WOON OCEAN 18

### 3,200BHP Towing Tug



#### GENERAL PARTICULARS

Flag	:	Singapore
Class	:	BV
Year Built	:	2008
Notation	:	I ✕ Hull ✕ Mach Tug, Unrestricted Navigation

#### PRINCIPAL DIMENSIONS

Length Moulded	:	36.00m
Breadth Moulded	:	10.40m
Depth Moulded	:	5.00m
Design Draft	:	4.00m
GRT / NRT	:	454 / 136

#### MACHINERY

Main Engine	:	2 x Cummins KTA 50-M2 1600BHP @ 1800 rpm
Generator	:	2 x Cummins 240 KW 415V/3/50Hz
Gearbox	:	Reintjes Gearbox Ratio 5.95:1
Bow Thruster	:	3 Tons, electric driven, model : ATB Sever
Steering Gear	:	Electro Hydraulic approx 3t.m x 35 deg x 2 Electro Hydraulic Steering Gear
Propulsion System	:	4 Blade Bronze, fixed pitch propellers with fixed nozzles

#### PERFORMANCE AND CONSUMPTION

Bollard Pull	:	40 Tons approx
Maximum Speed	:	12 Knots approx
Economical Speed	:	9.5 Knots approx
Fuel Consumption	:	10.5 Tons/day approx
Deck Strength	:	2.5 Tons/m <sup>2</sup>
Deck Space	:	113.96m <sup>2</sup>

Specifications are believed to be correct but not guaranteed. Updated on 24<sup>th</sup> June 2013

Page 1 of 3

### Tiong Woon Marine Pte Ltd

Co. Reg. No. 198301668R

No 15 Pandan Crescent, Singapore 128470

Tel: (65) 62617888 Fax: (65) 6777 4544

### Tiong Woon Corporation Holding Ltd

(Group Head Office)

Co. Reg. No. 199705837C

No 15 Pandan Crescent, Singapore 128470

Tel: (65) 6261 7888 Fax: (65) 6777 4544

Equipment Booking Hotline: (65) 6777 4450

Email: enquiry@tiongwoon.com

Webpage: www.tiongwoon.com



**TIONG WOON OCEAN 18**  
**3,200BHP Towing Tug**

**DECK MACHINERY & EQUIPMENT**

Anchor Windlass	:	1 x Electric-Hydraulic anchor windlass c/w double gypsy drum
Anchor	:	2 x 570kg stockless anchor
Anchor Chain	:	2 x Dia. 24mm studlink chains
Electro Tugger Winch	:	1 x 5T @ 15 m/min
Hyd Capstan	:	1 x 5T Electro Hyd. capstans with pulling force of 5 tons @ 15 m/min
Towing Winch	:	1 x Hyd. double drum
Wire Size	:	Dia. 44 mm x 600 m length
Line Pull (1 <sup>st</sup> )	:	40 Tons
Brake Holding	:	80 Tons on 1 <sup>st</sup> layer for each drum
Tow Pin	:	1 x 200Ton
Shark Jaw	:	1 x 200Ton
Stern Roller	:	1 x 150MT S.W.L.

**TANK CAPACITY**

Fuel Capacity	:	350m3 approx
Fresh Water Capacity	:	100 Tons approx
Lube Oil	:	3.0 Tons approx

**ACCOMODATION**

Berth	:	2 x 1 man cabin = 2 men
	:	1 x 2 men cabin = 2 men
	:	3 x 4 men cabin = <u>12 men</u>
Total		<u>16 men</u>
Sewage Plant	:	capacity 16 men

**NAVIGATION & COMMUNICATION EQUIPMENT**

Radar, Magnetic Compass, Echo Sounder, DGPS, Autopilot, GMDSS, MF/HF, VHF-DSC, Radar responder, EPIRB, Navtex Receiver, Inmarsat-C, SSB, SART, AIS

**FIREFIGHTING EQUIPMENT**

As per SOLAS requirement

**LIFE SAVING APPARATUS**

As per SOLAS requirement

**Tiong Woon Marine Pte Ltd**  
 Co. Reg. No. 198301668R  
 No 15 Pandan Crescent, Singapore 128470  
 Tel: (65) 62617888 Fax: (65) 6777 4544

**Tiong Woon Corporation Holding Ltd**  
 (Group Head Office)  
 Co. Reg. No. 199705837C  
 No 15 Pandan Crescent, Singapore 128470  
 Tel: (65) 6261 7888 Fax: (65) 6777 4544  
 Equipment Booking Hotline: (65) 6777 4450  
 Email: enquiry@tiongwoon.com  
 Webpage: www.tiongwoon.com





# TIONG WOON MARINE PTE LTD

-A member of Tiong Woon Corporation Holding Ltd-

## TIONG WOON OCEAN 18 3,200BHP Towing Tug

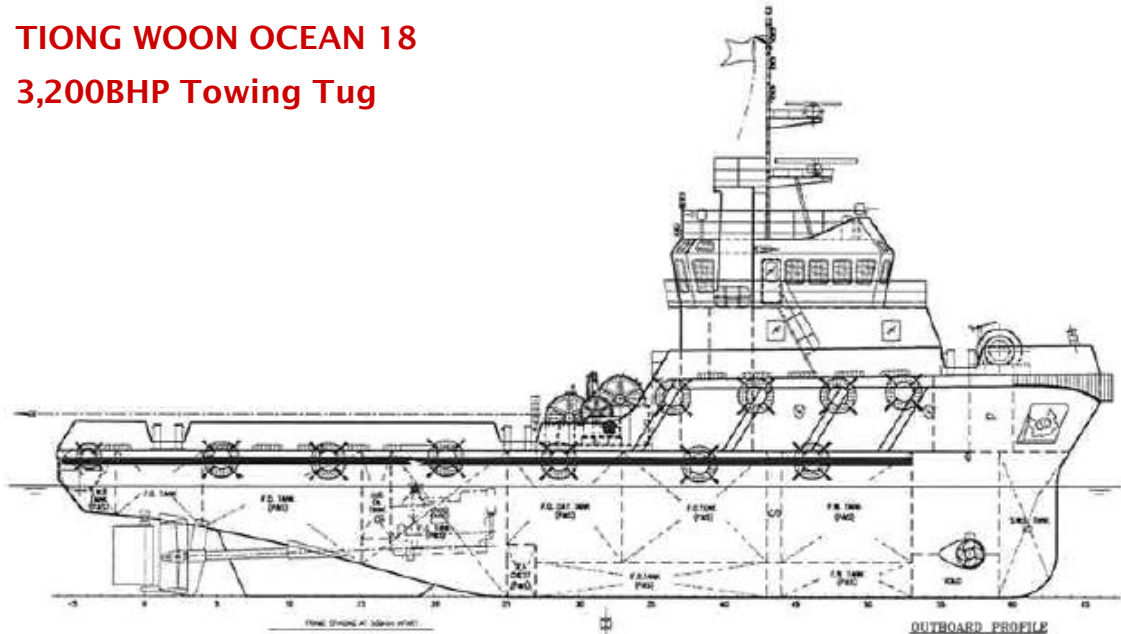

OUTBOARD PROFILE

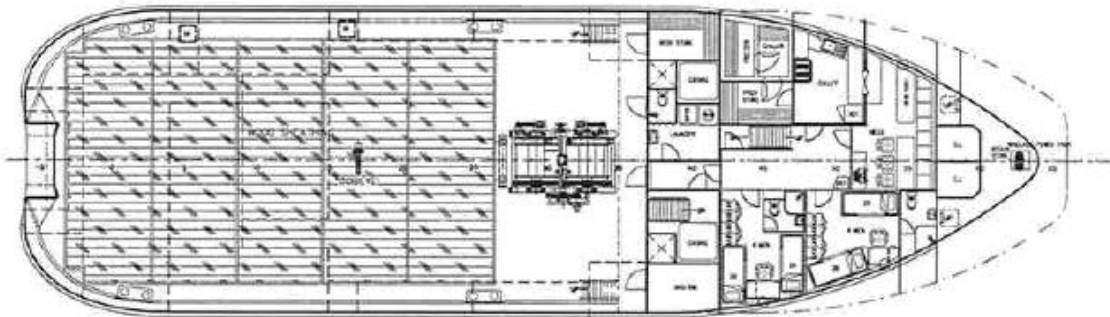

MAIN DECK PLAN

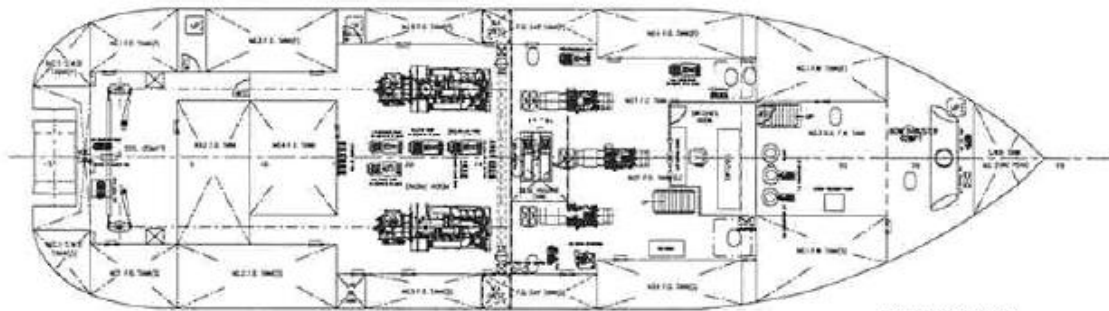

BELOW MAIN DECK

Specifications are believed to be correct but not guaranteed. Updated on 24<sup>th</sup> June 2013

Page 3 of 3

### Tiong Woon Marine Pte Ltd

Co. Reg. No. 198301668R

No 15 Pandan Crescent, Singapore 128470

Tel: (65) 62617888 Fax: (65) 6777 4544

### Tiong Woon Corporation Holding Ltd

(Group Head Office)

Co. Reg. No. 199705837C

No 15 Pandan Crescent, Singapore 128470

Tel: (65) 6261 7888 Fax: (65) 6777 4544

Equipment Booking Hotline: (65) 6777 4450

Email: enquiry@tiongwoon.com

Webpage: www.tiongwoon.com

